

How to install framed Shutters.

Freecall: 1 300 852 912

1. What you'll find in your Blinds On The Net DIY kit:

Shutter panels

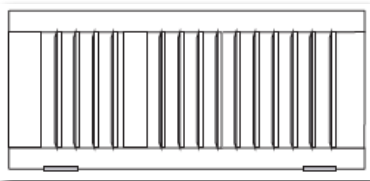

Frame



T Posts (if req)



Screws

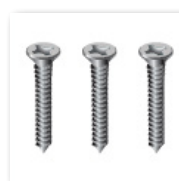

Hinge Pins



Gap Seal



2. Tools you'll also need:

Cordless drill +
Phillips head bit



3mm
Drill bit



Gap seal
applicator gun



3. Assemble your frame

Begin by working on a clean surface to avoid scratching the frame and panels (the inside of the cardboard packaging provided is a good surface to use).

Your frame will come in 3 or 4 pieces depending on your order. Each section is labelled to ensure that you match the correct panels with the correct hinges. Lay your frame out on the floor and clip each corner together using the Homan Keys provided. If you have T posts as part of your order you will then need to screw these in using the pre drilled holes as your reference point.

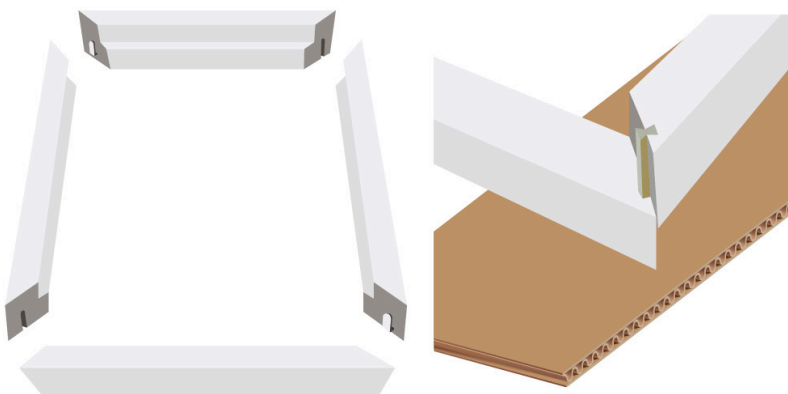

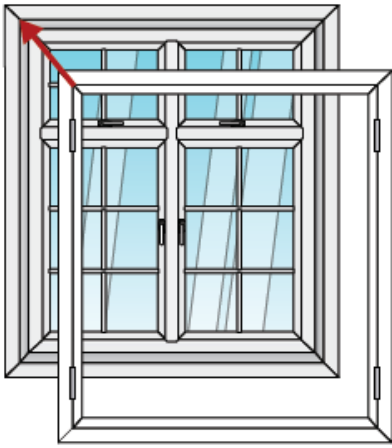

4. Mount your frame.

Carefully lift you frame into place. For larger windows it's a great idea to have someone help you with this step to ensure you don't damage the corners of the frame.

5. Recessed Fitting

Your frame will sit inside the window frame. You will need to pre drill holes facing the window frame. Pre drill 2 small holes on each side of the frame (8 in total - approximately 150mm from each corner). Screw your shutter frame to your window frame with the screws provided. Because not every window is square, you might need to back some screws in and out to keep the frame level at the top and bottom.

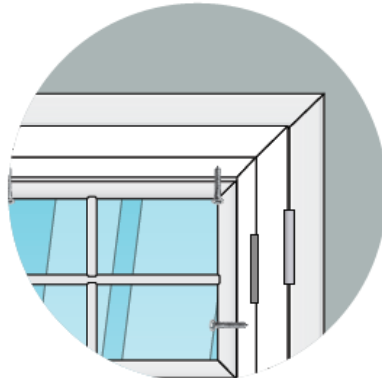
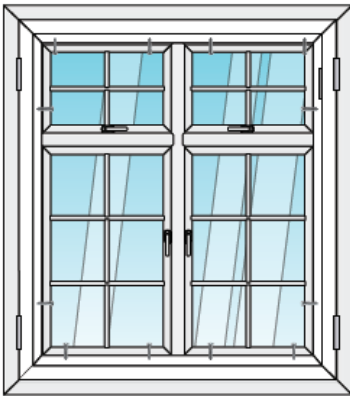

6. Face Fitting

Your frame will sit on the face of the window frame and you will need to predrill holes in the back of the frame facing towards the architrave of the window. Screw your shutter frame to your window frame with the screws provided. For larger windows you may need to fix additional screws in the mid point of the frame on each side.

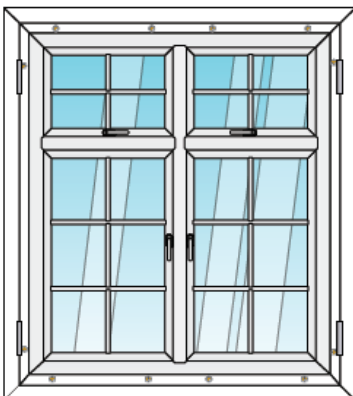

7. Mount your panels

Once your frame is secure, attach your panels to the frame using the provided hinge pins. The brackets should line up on the frame and the panel. If not, you may be trying to put the wrong panel on the wrong hinge.

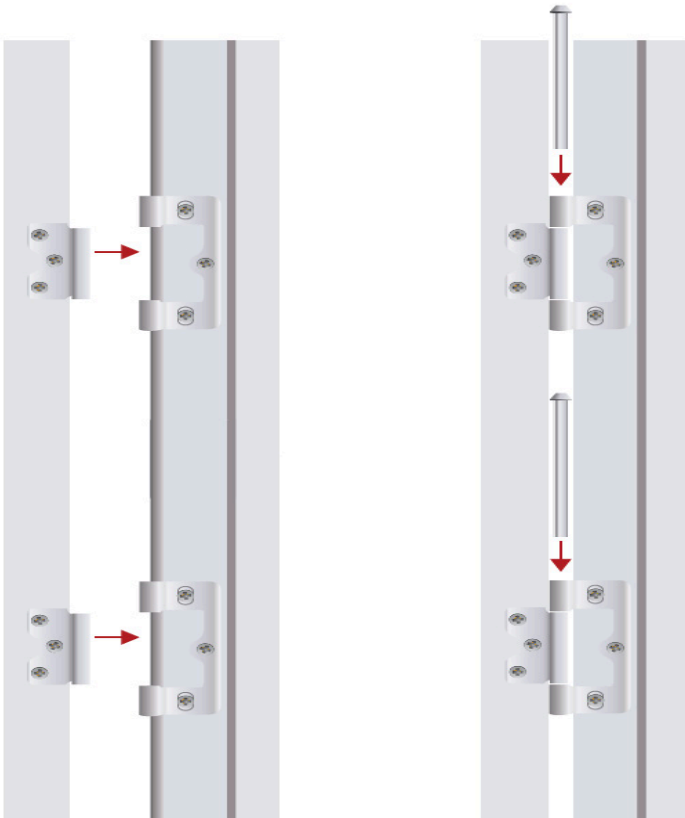

8. Square up your frame

Once all your panels are attached, test to see that they open and close with ease. Because of their weight, large panels may sit tight to the frame and need to be lifted in and out of place. This is normal so don't worry. You should have a nice even gap across the top between your panels and frame. If not you will need to back in and out one or more of the screws to straighten out the frame.

9. Fill your gaps

Once your frame and panels are installed and all is square it's now time for the fun part. For a professional finish use the gap filler provided to fill the gaps between your window frame and shutter frame. You might need to let it dry and apply a second filling to make sure all the light is being blocked out (often a good idea to check and redo if required in direct sunlight so you can see where you've missed).
